

BYLAW NO. 2013-02 Amend Official Community Plan

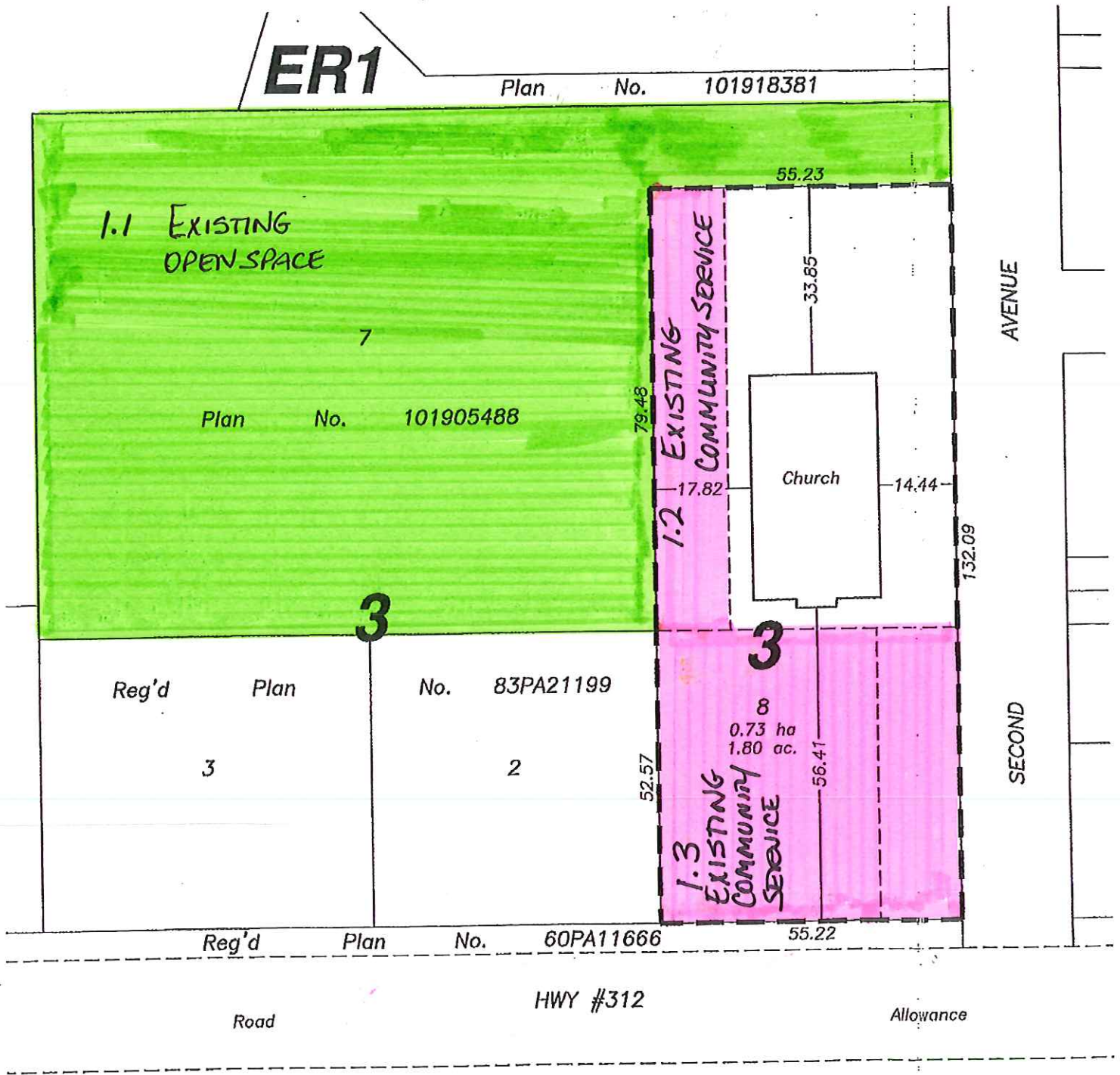

[Signature]
SASKATCHEWAN LAND SURVEYOR

Examined and Approved:
 La Corporation Episcopale
 Catholique Romaine
 de Prince Albert
 Town of Rosthern

[Signature]
 Representative
[Signature]
 Town Clerk

[Signature]
 Date
 April
 Date